

MEZZANINE FLOOR PLAN

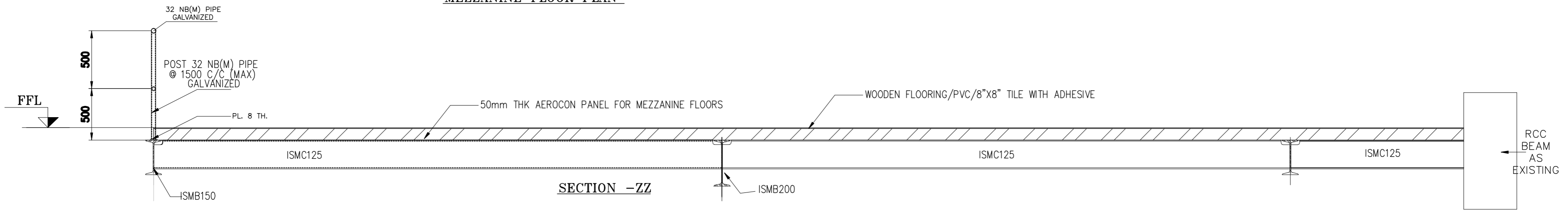

NOTE : THE FIXING DETAIL OF AEROCON MEZZANINE FLOORING STRICTLY AS PER MANUFACTURERS SPECIFICATIONS

GENERAL NOTES:  
UNLESS OTHERWISE MENTIONED

1. ALL DIMENSIONS ARE IN MILLIMETERS & LEVELS ARE IN M.
2. ALL FILLET WELDS ARE 6MM THICK.
3. ALL HOLES ARE 18 mm DIA FOR 16 mm DIA BOLTS.
4. DO NOT SCALE THE DRAWING.
5. TRUE DIMENSIONS SHALL BE TAKEN FROM THE LAYOUT.
6. STRUCTURAL STEEL SHALL CONFIRM TO IS-226 (LATEST) AND FABRICATION TO IS-800 (LATEST).

LEGEND	
TOS	: TOP OF SLAB
FFL	: FINISHED FLOOR LEVEL
TYP	: TYPICAL

PROJECT:	PROPOSED MEZZANINE FLOOR	TITLE:	BL LOGISTICS SAMSHABAD (MEZZANINE FLOOR DETAILS)
CLIENT:	BALMER LAWRIE	DRAWN:	VIDYA
CHECKED:	KINC	APPROVED:	J.P.
DATE:	8-12-2016	PLOT SCALE:	NTS
REV.	DATE	MODIFICATION	REV. BY
			CHKD. BY
			APP. BY
			REVISION

INDRAPRASTA CONSULTANTS  
STRUCTURAL ENGINEERS ARCHITECTS & INTERIOR DESIGNERS  
810, 2ND FLOOR, FLAT - 302, ROAD NO. 2  
CASTLE HILLS, WASAB TANK  
HYDERABAD - 500057  
PHONE NO. 23535442, 98480-25598  
E-mail : shekar1@satyam.net.in

DRAWING NO: IP/MS/STR/01